

AMAZON2

700 Series



Overview

The Amazon2 700 series are the new industrial digital camera range which compliant with both Gigabit Ethernet and with the GigE Vision standard. It provides high quality performance and various resolutions and frame rates with more competitive pricing level to offer more benefits to customers. Above all, the small sized housing up to 29mm x 29mm is the most important advantage offering multipurpose industrial camera applications. Enjoy our new GigE Vision camera, Amazon2 700 series and make your various industrial vision projects more successful and efficient.

Dimension

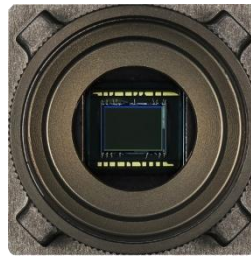
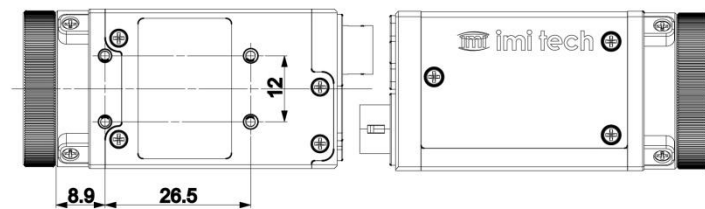
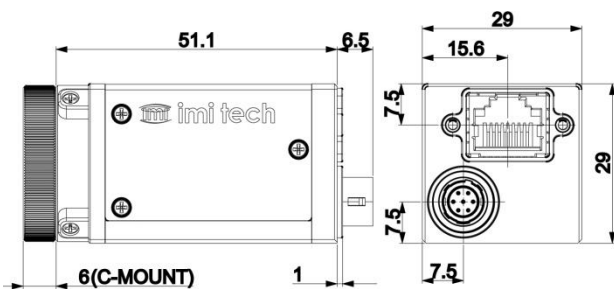

Specifications

Model		IMx-750GC	IMx-720G	IMx-717G	IMx-716G	IMC-715G2
Image Sensor		1/2.5" Aptina CMOS	1/1.8" Sony CCD	1/2" Sony CCD	1/3" Sony CCD	1/3" Sony CCD
Sensor Name		MT9P031	ICX274 AL/AQ	ICX267 AL/AK	ICX445 ALA/AQA	ICX692 AQA
Resolution	Megapixel	5.0MP	2.0MP	1.4MP	1.3MP	0.95MP
	HxV	2592 x 1944	1624 x 1232 (Mono) 1624 x 1228 (Color)	1388 x 1040 (Mono) 1388 x 1036 (Color)	1288 x 964 (Mono) 1288 x 960 (Color)	1280 x 720
Pixel Size		2.2µm x 2.2µm	4.40µm x 4.40µm	4.65µm x 4.65µm	3.75µm x 3.75µm	4.08µm x 4.08µm
Frame Rate		14 fps	16 fps	20 fps	30 fps	30 fps
Digital Interface		Gigabit Ethernet				
Transfer Rate		1000 Mbps				
Scanning System		Partial Scan	Progressive Scan			
Shutter Type		Rolling Shutter	Global Shutter			
Data Path		12 bit	8 or 12 bit B/W (YUV 4:2:2 / YUV 4:1:1)			
Binning		-	2x2 (Mono only) * Color/Mono is available for Imx-720G			
ROI		Partial Scan (Unit:4x4)				
Trigger		External or Software Trigger with various mode				
I/O Port		Ext. Trigger, RS232, Strobe (6-pin)				
Memory Save/Load		9 Channels (0:factory, 1~4:feature, 5~8:mode/feature)				
Gain Control		0 ~ 27.6 dB (Manual or Auto control)	0 ~ 18 dB (Manual or Auto)			
Shutter Speed		500 usec ~ 70.6 msec (Manual or Auto control)	1 µsec ~ 3600 sec			
Control Functions		Brightness, Sharpness, Gamma, Auto-gain, Auto-Exposure, Auto-Shutter, (Saturation, Auto White Balance, Hue)				
Lens Mount		C/CS Mount				
Operating Temp.		-5°C ~ 45°C				
Storage Temp.		-30°C ~ 60°C				
Supply Voltage		PoE (Power over Ethernet 802.3af compliant) or +8 VDC ~ 24 VDC supplied via the camera's 6-pin Hirose connector				
		< 2.6 W (when using Power over Ethernet) < 2.4 W (@ 12 VDC when supplied via the camera's 6-pin connector)	< 3.2 W (when using Power over Ethernet) < 3.0 W (@ 12 VDC when supplied via the camera's 6-pin connector)	< 2.5 W (when using Power over Ethernet) < 2.7 W (@ 12 VDC when supplied via the camera's 6-pin connector)		
Dimension		29(W)x29(H)x51.1(D)mm (without lens adapter)				
Weight		< 58 g				

Note : Specification may be subject to change without notice.



imi tech

(431-767) #616, Mega Valley, 799, Gwanyang 2-dong,
Dongan-gu, Anyang-si, Gyeonggi-do, Korea
TEL : +82-31-423-9801(rep), FAX : +82-31-423-9803,

<http://www.imi-tech.com>

Specifications

Model		IMx-715G	IMx-712G	IMx-711G	IMx-710G
Image Sensor		1/3" Sony CCD	1/2" Sony CCD	1/3" Sony CCD	1/4" Sony CCD
Sensor Name		ICX204 AQA	ICX414 AL/AQ	ICX424 AL/AQ	ICX618 ALA/AQA
Resolution	Megapixel	0.78MP	0.3MP	0.3MP	0.3MP
	HxV	1032 x 776 (Mono) 1028 x 772 (Color)	656 x 484 (Mono) 652 x 480 (Color)	656 x 488 (Mono) 652 x 484 (Color)	656 x 488
Pixel Size		4.65µm x 4.65µm	9.90µm x 9.90µm	7.40µm x 7.40µm	5.60µm x 5.60µm
Frame Rate		35 fps	90 fps	90 fps	100 fps
Digital Interface		Gigabit Ethernet			
Transfer Rate		1000 Mbps			
Scanning System		Progressive Scan			
Shutter Type		Global Shutter			
Data Path		8 or 12 bit B/W (YUV 4:2:2 / YUV 4:1:1)			
Binning		2x2 (Mono only) * Color/Mono is available for Imx-720G			
ROI		Partial Scan (Unit:4x4)			
Trigger		External or Software Trigger with various mode			
I/O Port		Ext. Trigger, RS232, Strobe (6-pin)			
Memory Save/Load		9 Channels (0:factory, 1~4:feature, 5~8:mode/feature)			
Gain Control		0 ~ 18 dB (Manual or Auto)			
Shutter Speed		1 µsec ~ 3600 sec			
Control Functions		Brightness, Sharpness, Gamma, Auto-gain, Auto-Exposure, Auto-Shutter, (Saturation, Auto White Balance, Hue)			
Lens Mount		C/CS Mount			
Operating Temp.		-5°C ~ 45°C			
Storage Temp.		-30°C ~ 60°C			
Supply Voltage		PoE (Power over Ethernet 802.3af compliant) or +8 VDC ~ 24 VDC supplied via the camera's 6-pin Hirose connector			
		< 2.5 W (when using Power over Ethernet) < 2.7 W (@ 12 VDC when supplied via the camera's 6-pin connector)			
Dimension		29(W)x29(H)x51.1(D)mm (without lens adapter)			
Weight		< 58 g			

Note : Specification may be subject to change without notice.



imi tech

(431-767) #616, Mega Valley, 799, Gwanyang 2-dong,
Dongan-gu, Anyang-si, Gyeonggi-do, Korea
TEL : +82-31-423-9801(rep), FAX : +82-31-423-9803,

<http://www.imi-tech.com>