

[SPEC F CAT DNS] **3.6Megapixel motorized Zoom Lens**

Image Size: $\frac{2}{3}$ $\frac{1}{2}$ $\frac{1}{3}$

Focal Length :	11-66mm	Photometry Range :	Approx. 40% - 70% Variable to Vp-p
Maximum Relative Aperture :	1:1.8(Tele End 1:1.8)	Input Impedance :	High Impedance
Iris :	F1.8 - Approx.1,200(With ND Spot Filter)	Operation : Zoom :	Motorized(DC+/-6.4V, Max45mA) Speed Approx. 8.0sec.
Zoom Ratio :	6x	Focus :	Motorized(DC+/-6.4V, Max45mA) Speed Approx. 8.5sec.
Angular Field of View :	43.3X33.0 deg at 11mm 7.7X5.8 deg at 66mm	Iris :	EE(DC+8.5 to 16V : Fixed Voltage, Max45mA) Speed Within 3sec.
Image Format :	8.8X6.6mm	EE Mechanism :	The built-in EE Amp amplifies the difference between the video signal from the camera and the preset Iris signal level. It causes the Iris to change size.
Minimum Object Distance :	1.4m(From Front Vertex)	EE Accuracy :	With Input Video Signal 0.7Vp-p within+/-15% of Mean Value
Object Dimensions at M.O.D. :		Operation Temperature :	-10 to +50
Optical Back Focal Distance :	111.1X82.9 at 11mm 18.8X14.2 at 66mm	Mount :	C-Mount(Adjustable Lens Position)
Flange Back :	15.28mm(In Air)	Front Thread :	72mm P0.75
Input Signal :	17.526mm	Size, Weight :	84.5X85X120mm, Approx. 700g
Sensitivity Adjustment:	Composite Video Signal or Video Signal 0.5-1.0Vp-p(Image-Signal)		

[COMPOSITION]

Lens1
Lens Cap1
Dust Cap1

4-Conductor Connector(Female)1
(Any 4-conductor cable of external dia 6mm to be prepared separately.)

[DIMENSIONS]

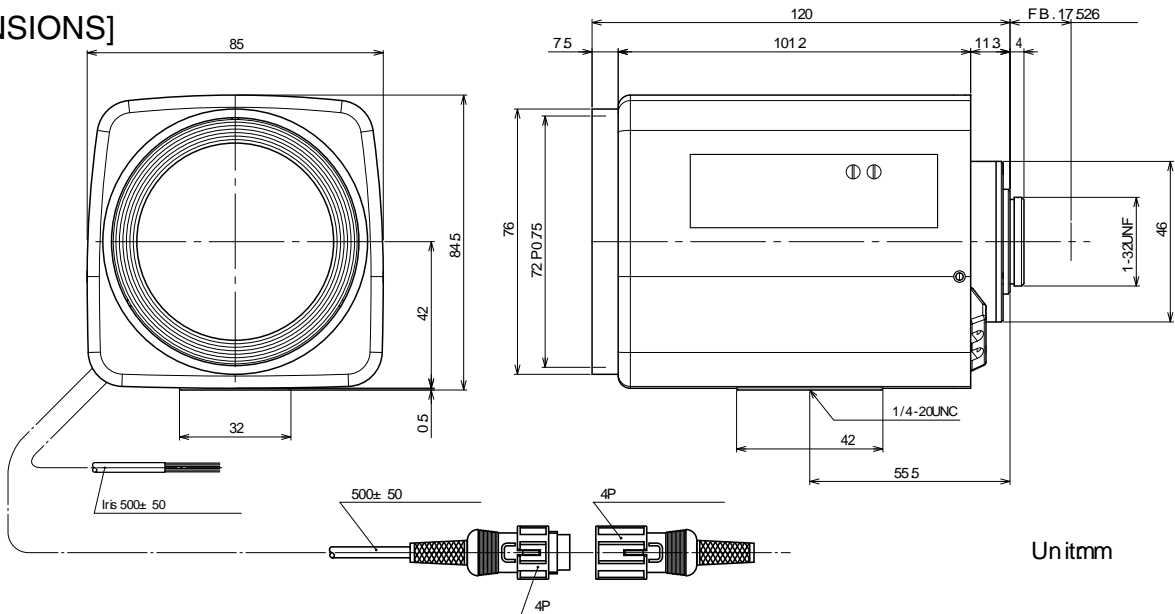

[CIRCUIT DIAGRAM]

